

LOWER RIO GRANDE PUBLIC WATER WORKS AUTHORITY

SERVICE AREAS

FEBRUARY 2016

SCALE: 1" = 7,000'

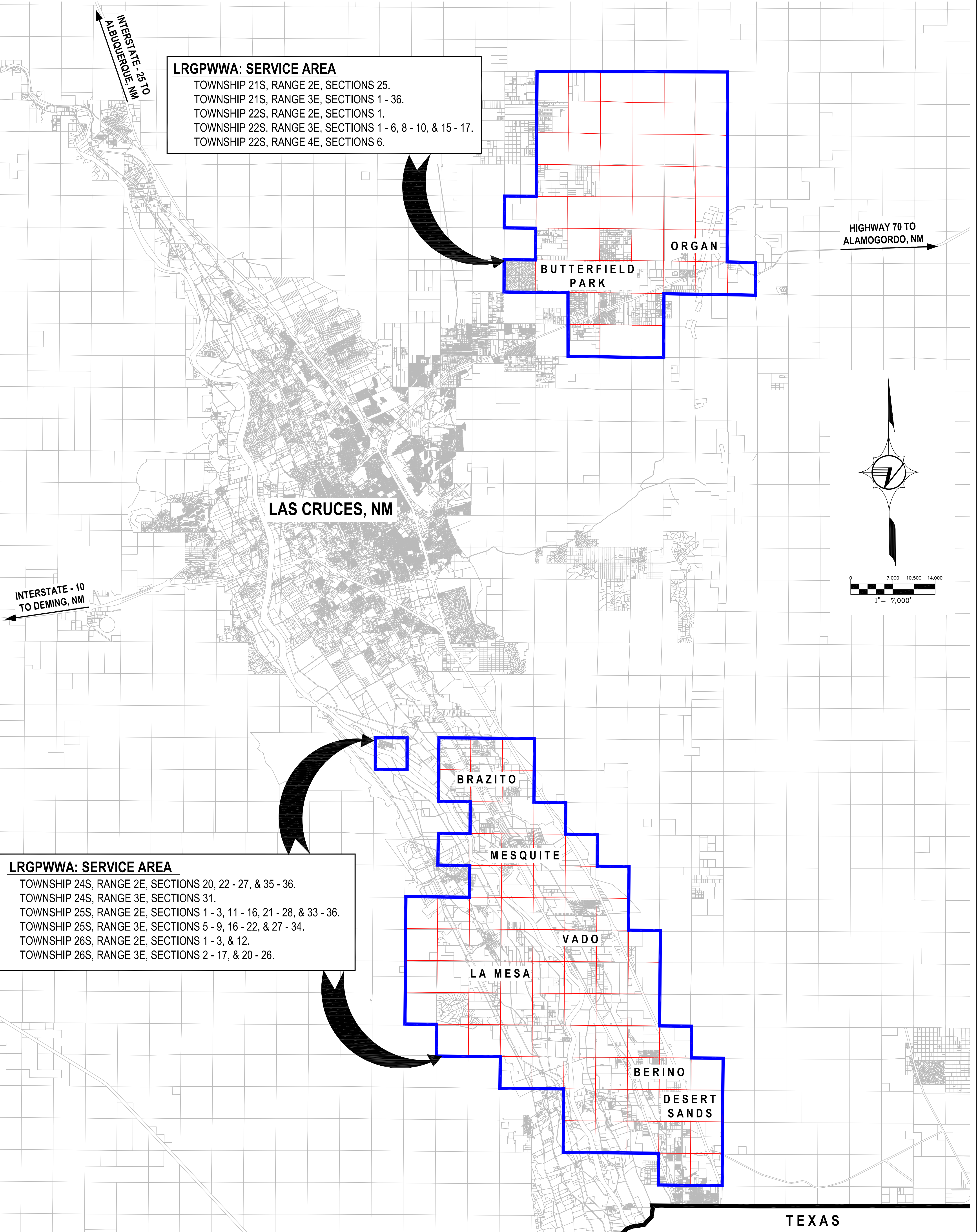

LRGPWWA: SERVICE AREA
 TOWNSHIP 21S, RANGE 2E, SECTIONS 25.
 TOWNSHIP 21S, RANGE 3E, SECTIONS 1 - 36.
 TOWNSHIP 22S, RANGE 2E, SECTIONS 1.
 TOWNSHIP 22S, RANGE 3E, SECTIONS 1 - 6, 8 - 10, & 15 - 17.
 TOWNSHIP 22S, RANGE 4E, SECTIONS 6.

LRGPWWA: SERVICE AREA
 TOWNSHIP 24S, RANGE 2E, SECTIONS 20, 22 - 27, & 35 - 36.
 TOWNSHIP 24S, RANGE 3E, SECTIONS 31.
 TOWNSHIP 25S, RANGE 2E, SECTIONS 1 - 3, 11 - 16, 21 - 28, & 33 - 36.
 TOWNSHIP 25S, RANGE 3E, SECTIONS 5 - 9, 16 - 22, & 27 - 34.
 TOWNSHIP 26S, RANGE 2E, SECTIONS 1 - 3, & 12.
 TOWNSHIP 26S, RANGE 3E, SECTIONS 2 - 17, & 20 - 26.

LEGEND

- SERVICE AREA
- SECTION BOUNDARY
- DONA ANA COUNTY PARCEL LINE

LRGPWWA SIGNATURE

THIS IS A TRUE AND CORRECT COPY OF THE SERVICE AREA DECLARED BY THE BOARD OF THE LOWER RIO GRANDE PUBLIC WATER WORKS AUTHORITY ON THE _____ DAY OF _____, 2016, PURSUANT TO NMSA 1978 SECTION 73-26-1(D)-(E).

CHAIRMAN	DATE	(SEAL)
SECRETARY	DATE	(SEAL)

LRGPWWA STAMP